

VELUX CGL Roof Window installation guidelines for roofs with roof pitch less than 15 degrees

For roofs with roof pitches less than 15 degrees, the VELUX CGL Roof Window must be installed to a min. 15 degrees. A purpose made flashing designed to meet the conditions set out in Section E2 of the New Zealand Building Code shall be manufactured and installed by a specialist flashing contractor. This flashing must be guaranteed against weather-tightness by the specialist flashing contractor. Insulation material meeting the requirements of NZBC/H1 is required in the cavities of the lightwell structure.

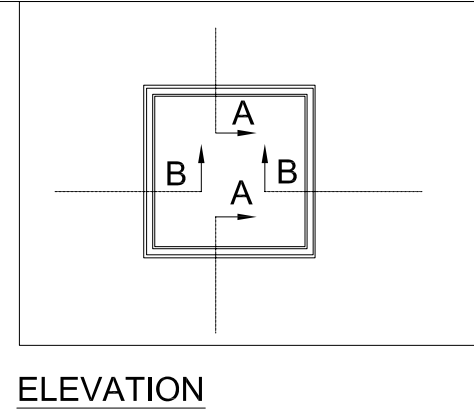

ELEVATION

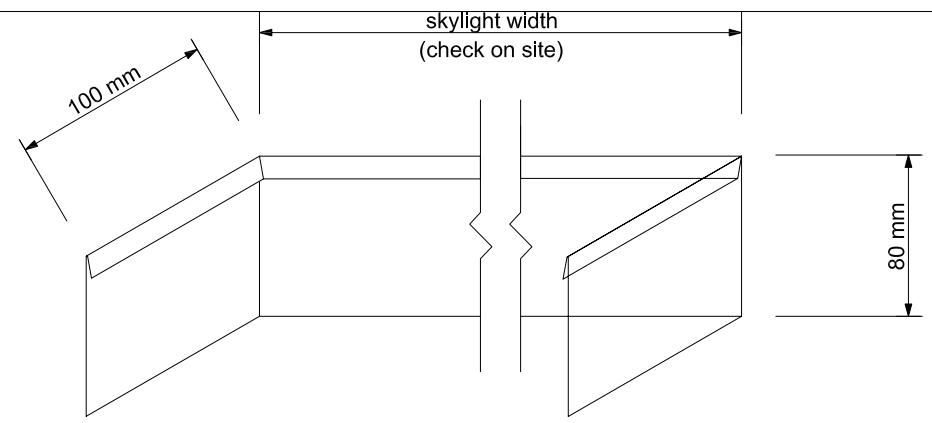
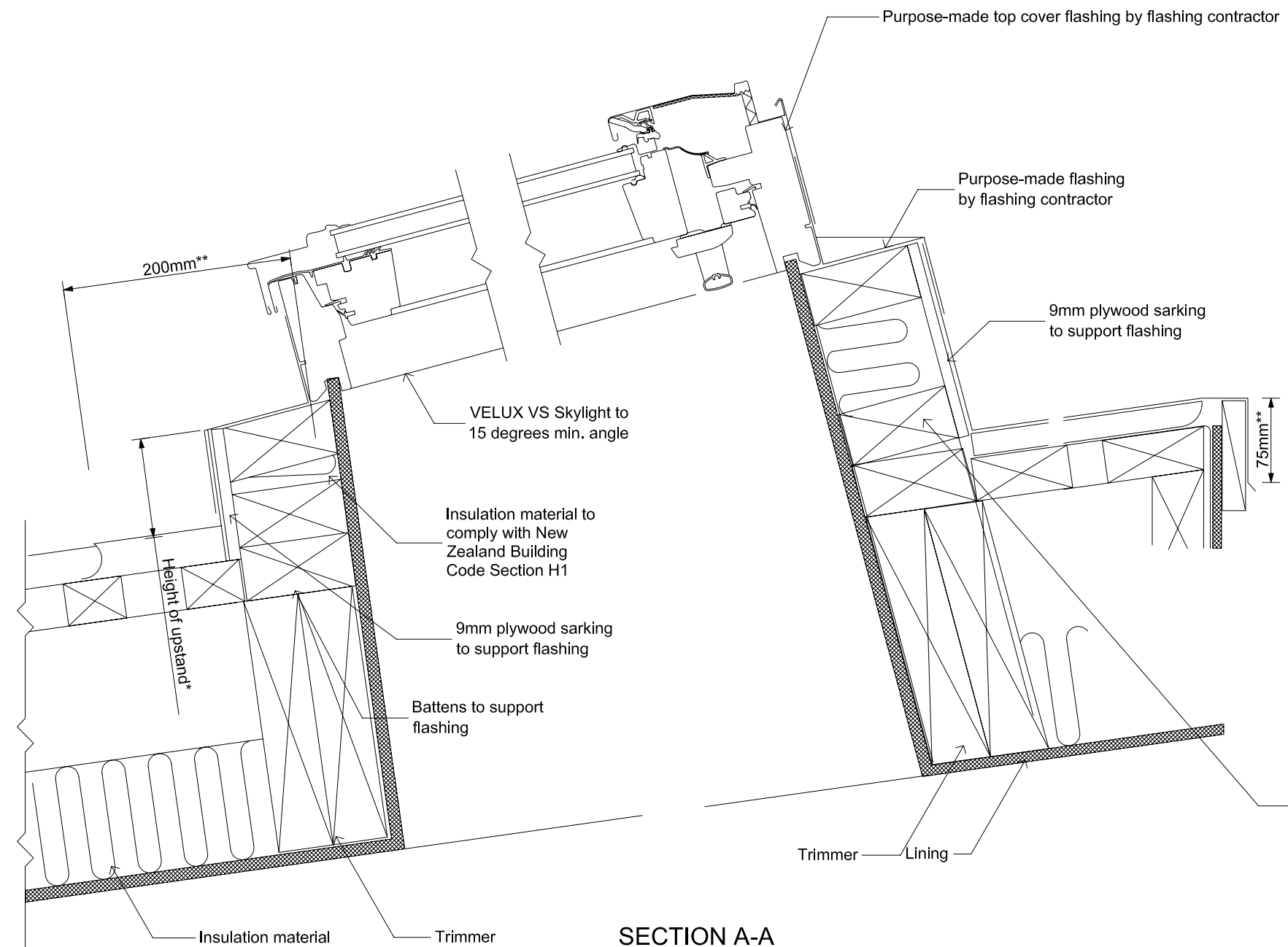

SECTION A-A

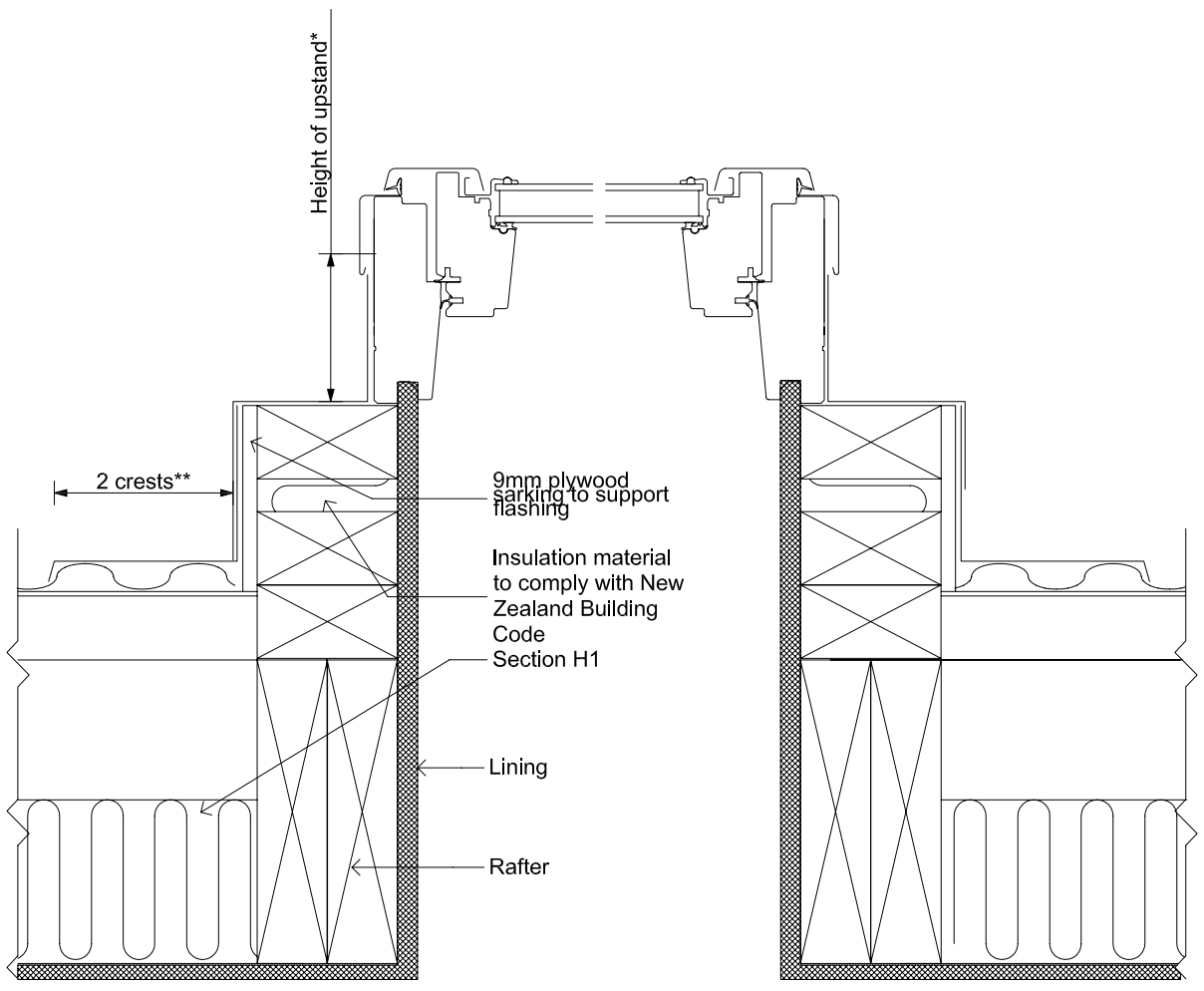

SECTION B-B

**INSTALLATION GUIDELINES - GGL ROOF WINDOW IN METAL ROOFS (PITCH < 15 DEGREES)**

<b>VELUX</b>	<b>NEW ZEALAND LTD.</b>		Name	Date
	Sky-Product Management		0800 650 445	June 09
GGL - Roof Window in Metal Roof (pitch <15 degrees)			Checked by	June 09
			Drawing No.	

This drawing is an instrument of service and is provided for informational use only.