

VELUX FS Fixed Skylight installation guidelines for roofs with roof pitch less than 15 degrees

For roofs with roof pitches less than 15 degrees, the VELUX FS Fixed Skylight must be installed to a min. 15 degrees.
 A purpose made flashing designed to meet the conditions set out in Section E2 of the New Zealand Building Code shall be manufactured and installed by a specialist flashing contractor. This flashing must be guaranteed against weather-tightness by the specialist flashing contractor.
 Insulation material meeting the requirements of NZBC/H1 is required in the cavities of the lightwell structure.

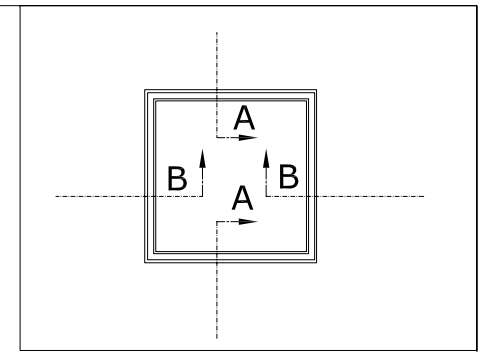

ELEVATION

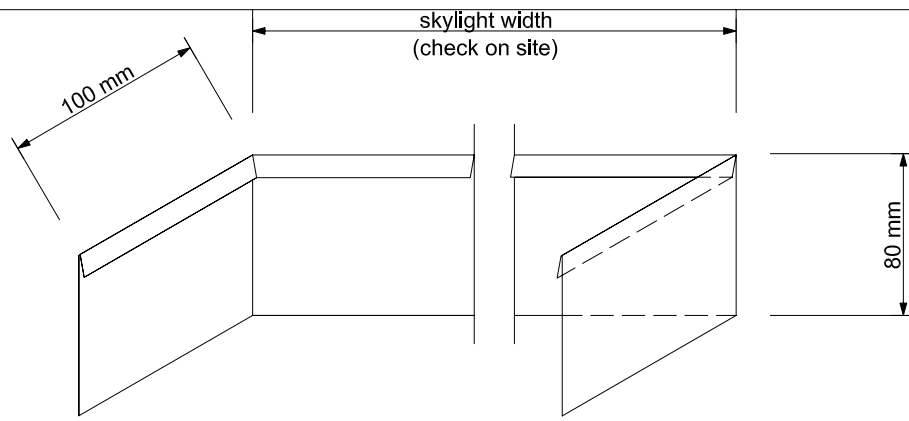
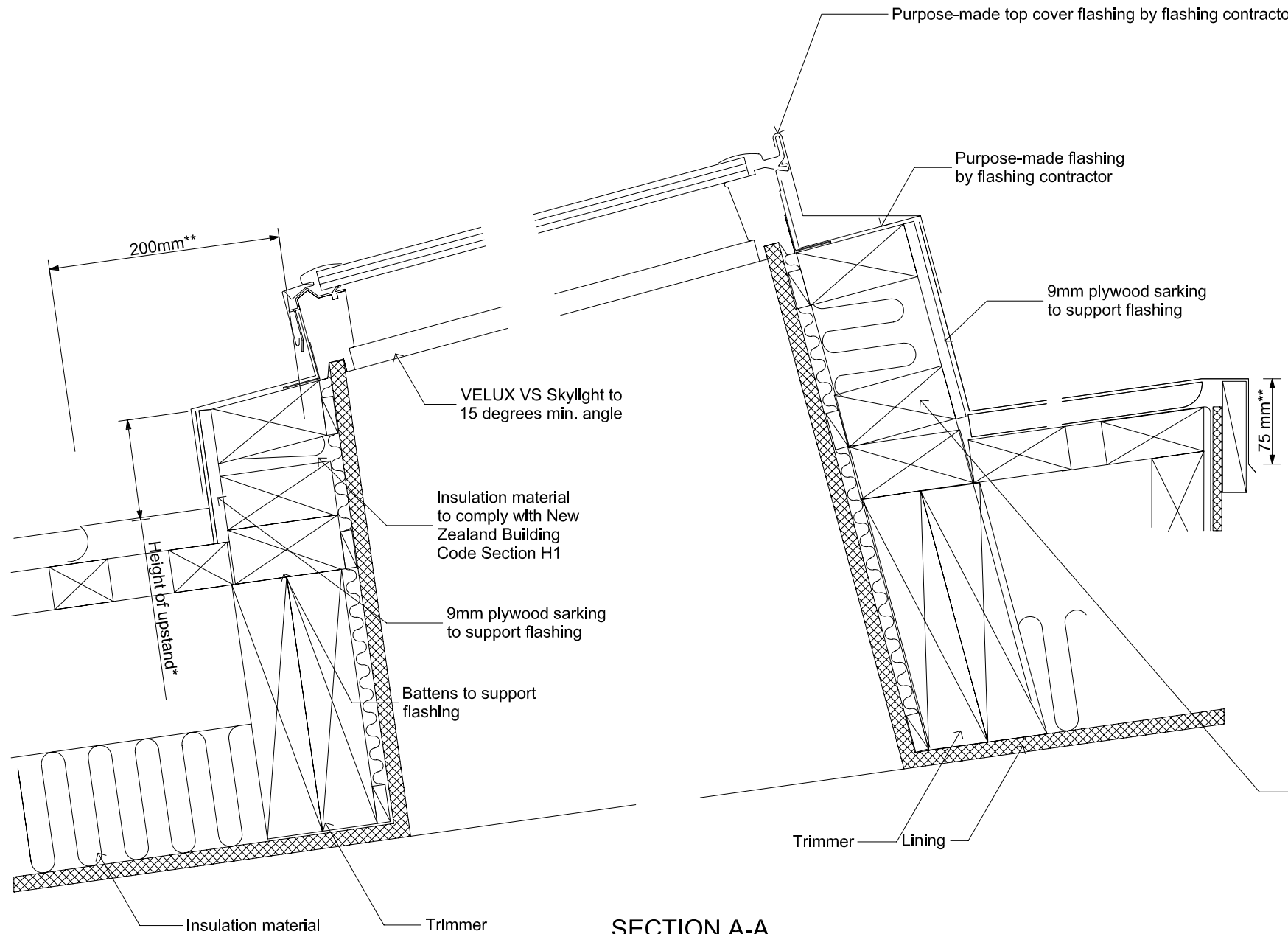

SECTION A-A

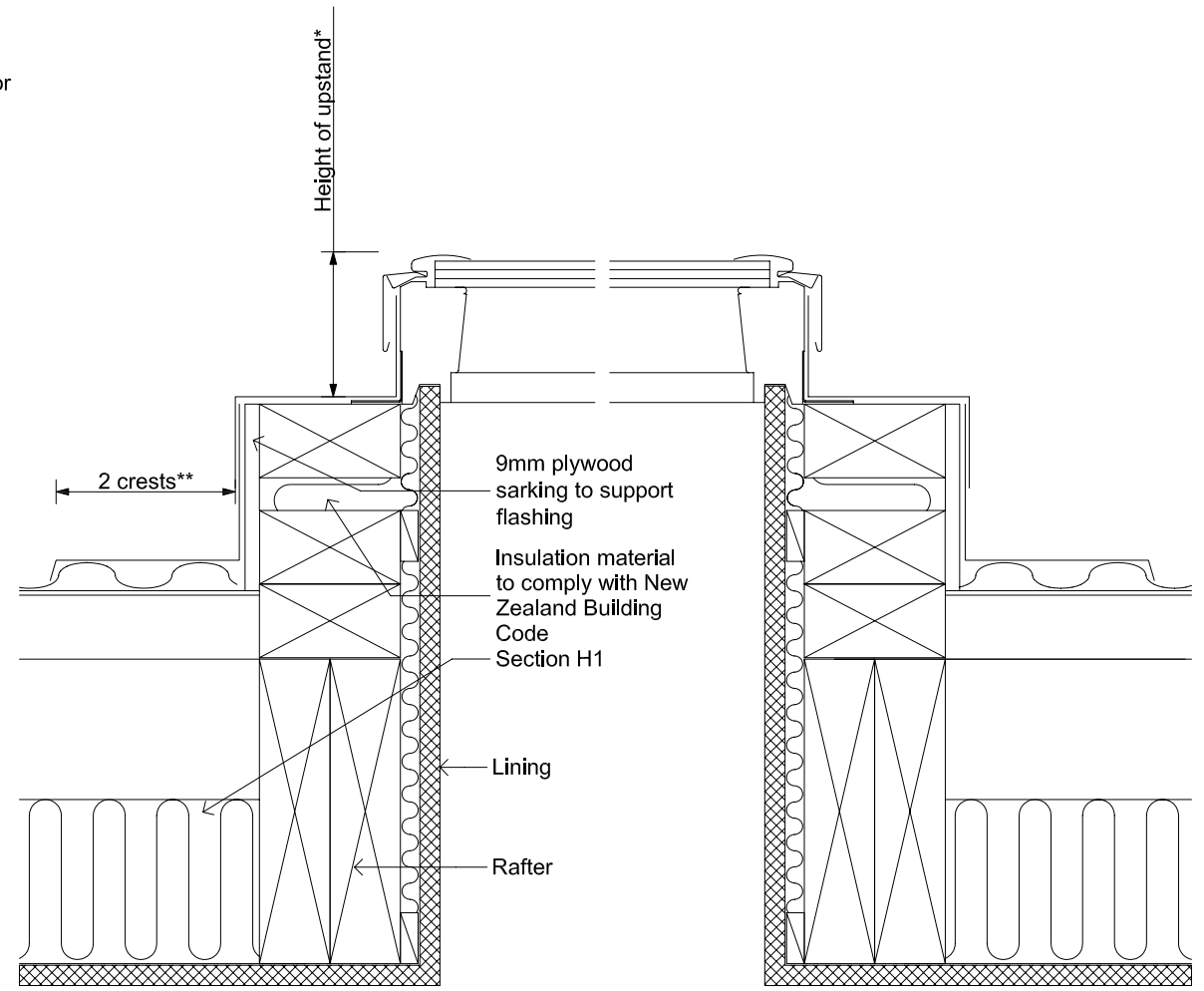

SECTION B-B

INSTALLATION GUIDELINES - FS FIXED SKYLIGHT IN METAL ROOFS (PITCH < 15 DEGREES)

VELUX Sky-Product Management	NEW ZEALAND LTD. 0800 650 445		Name	Date
	Drawn by			Oct 09
FS - Fixed Skylight in Metal Roof (pitch <15 degrees)		Checked by		Oct 09
		Drawing No.		

This drawing is an instrument of service and is provided for informational use only.
 © 2009 VELUX GROUP